

Plan  
Scale 1:10,000 @ A1

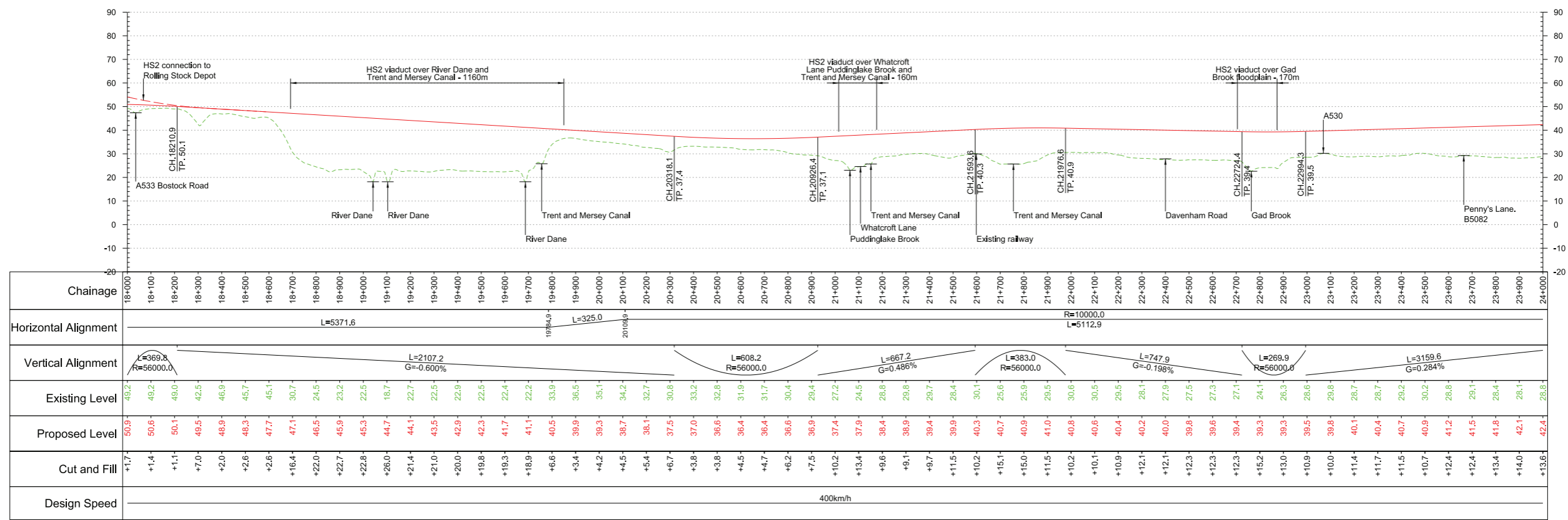

Profile  
Scale H:1:10,000 V:1:1000 @ A1

**Fit for Acceptance**



Rev	Description	Drawn	Checked	Con App	HS2 App
P04	Updated to comments (annotation only)	KB	DC	JG	11/16
P03	Updated to comments (annotation only)	KB	DC	JG	04/16
P02	Updated to comments (annotation only)	KB	DC	JG	11/16
P01	First Issue	KB	DC	JG	14/16

HS2 accepts no responsibility for any circumstances which arise from the reproduction of this document after alteration, amendment or abbreviation or if it is issued in part or issued incompletely in any way.

© Crown Copyright and database right 2016. All rights reserved. Ordnance Survey Licence number 100049190

© Crown Copyright material is reproduced with the permission of Land Registry under delegated authority from the Controller of HMSO.

This material was last updated on 2016 and may not be copied, distributed, sold or published without the formal permission of Land Registry. Only an official copy of a title plan or register obtained from the Land Registry may be used for legal or other official purposes.

Scale with caution as distortion can occur.

Key Environmental Features Legend	
	World Heritage Site
	Ramsar
	Special Areas of Conservation
	Special Protection Areas
	SSSI
	National Nature Reserves
	Area of Outstanding Natural Beauty
	National Park
	Major Development Sites
	Additional Development Sites
	Scheduled Monuments
	Registered Parks and Gardens
	Historical Battlefields
	Active and/or Authorised Landfill
	Historical Landfill
	Flood Zones
	Listed Building Grade I
	Listed Building Grade II*
	Listed Building Grade II

Legend	
	Track Centrelines
	Viaduct
	Tunnel
	Existing Railway Connection
	HS2 Connection
	Fully Retained Cutting/Fill
	Major Contour
	Ground Profile
	Track Profile
	Minor Contour
	Node
	Engineering Earthworks
	Railway Cutting
	Railway Embankment
	HS2 Depot/Station Operational Boundary

Registered in England  
Registration No. 06791686  
Registered office:  
One Canada Square,  
London, E14 5AB

Creator/Originator  
**AECOM**

Zone	Manchester Leg North of Crewe
Design Stage	Post-Consultation
Drawing Title	Preferred Route - HSM10B
	Plan and Profile
	Sheet 4 of 6

Project/Contract		
West Midlands to Manchester Route		
Discipline/Function		
Railway Track		
Drawn	Checked	Approved
KB	DC	JG
Date	Scale	Size
11/01/2016	AS SHOWN	A1
Drawing No.		Rev.
C320-AEC-RT-DPP-220-065104		P04