

**Plan**  
Scale 1:5,000 @ A1

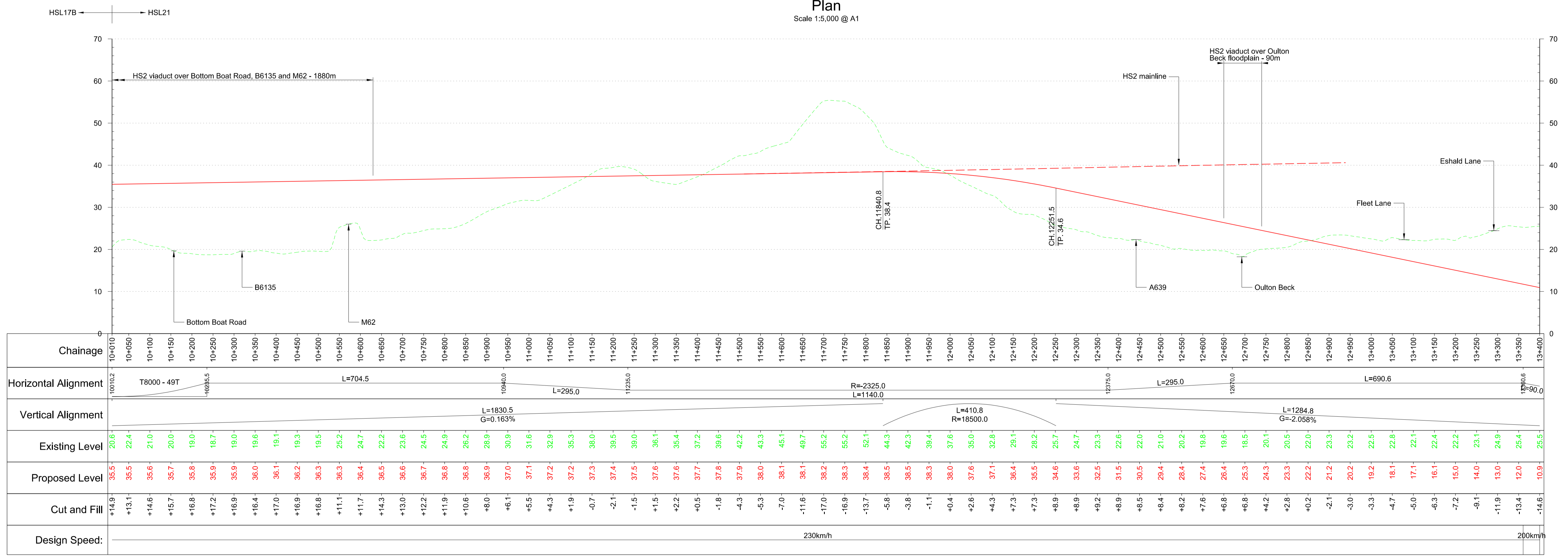

**Profile**  
Scale H:1:5,000 V:1:500 @ A1

**Fit for Acceptance**

P03	Client's Comments Addressed	JV	AR	MM	09/11/16	09/11/16	09/11/16	HS2 accepts no responsibility for any circumstances which arise from the reproduction of this document after alteration, amendment or abbreviation or if it is issued in part or issued incompletely in any way.
P02	Client's Comments Addressed	JV	AR	MM	14/10/16	14/10/16	14/10/16	© Crown Copyright and database right 2016. All rights reserved. Ordnance Survey Licence number 100049190
P01	First Issue	RB	AR	MM	15/07/16	15/07/16	15/07/16	© Crown Copyright material is reproduced with the permission of Land Registry under delegated authority from the Controller of HMSO. This material was last updated on 2016 and may not be copied, distributed, sold or published without the formal permission of Land Registry. Only an official copy of a title plan or register obtained from the Land Registry may be used for legal or other official purposes.
Rev	Description	Drawn	Checked	Con App	HS2 App	Scale with caution as distortion can occur.		

<b>Key Environmental Features Legend</b> <ul style="list-style-type: none"> <li>World Heritage Site</li> <li>Ramsar</li> <li>Special Areas of Conservation</li> <li>Special Protection Areas</li> <li>SSSI</li> <li>National Nature Reserves</li> <li>Area of Outstanding Natural Beauty</li> <li>National Park</li> <li>Major Development Sites</li> <li>Additional Development Sites</li> </ul>		<b>Legends/Notes:</b> <ul style="list-style-type: none"> <li>Scheduled Monuments</li> <li>Registered Parks and Gardens</li> <li>Historical Battlefields</li> <li>Active and/or Authorised Landfill</li> <li>Historical Landfill</li> <li>Flood Zones</li> <li>Listed Building Grade I</li> <li>Listed Building Grade II*</li> <li>Listed Building Grade II</li> </ul>		<b>Legend</b> <ul style="list-style-type: none"> <li>Track Centrelines</li> <li>Viaduct</li> <li>Tunnel</li> <li>Existing Railway Connection</li> <li>HS2 Connection</li> <li>Fully Retained Cutting/Fill</li> <li>Major Contour</li> <li>Ground Profile</li> <li>Track Profile</li> <li>Minor Contour</li> <li>Node</li> </ul>		<b>Engineering Earthworks</b> <ul style="list-style-type: none"> <li>Railway Cutting</li> <li>Railway Embankment</li> <li>HS2 Depot/Station Operational Boundary</li> </ul>	
--	--	--	--	--	--	--	--

	Registered in England Registration No. 06791666 Registered office: One Canada Square, London, E14 5AB
Creator/Organator <b>Mott MacDonald</b>	

Zone <b>Leeds Metropolitan Spur</b>	Project/Contract <b>West Midlands to Leeds Route</b>
Design Stage <b>Post-Consultation</b>	Discipline/Function <b>Railway Track</b>
Drawing Title <b>HSL21 Preferred Route</b>	Drawn <b>JV</b>
Sheet 1 of 2	Checked <b>AR</b>
	Approved <b>MM</b>
	Date <b>09/06/2016</b>
	Scale <b>1:5000</b>
	Size <b>A1</b>
	Drawing No. <b>C321-MMD-RT-DPP-140-582101</b>
	Rev. <b>P03</b>